

AERODROME CHART - ICAO		53 25 17 N	ELEV 242 FT	TWR 118.600 GND 121.800 ATIS 124.525
		006 16 12 W		
RWY	DIRECTION	THR		BEARING STRENGTH
10	99°	53 25 20.75 N	006 17 24.27 W	PCN 70/R/B/W/T
28	279°	53 25 12.94 N	006 15 02.08 W	
16	160°	53 26 13.16 N	006 15 43.12 W	
34	340°	53 25 11.66 N	006 14 58.54 W	PCN 75/R/D/W/T

LEGEND	
RVR	◁
DISUSED PAVEMENT	X
STOPBAR	●●●●
RUNWAY HOLDING POSITION MARKINGS	▬▬▬▬
HOT SPOT	○
CLEARWAY	□
STOPWAY	□
ENGINE TEST SITE	✳

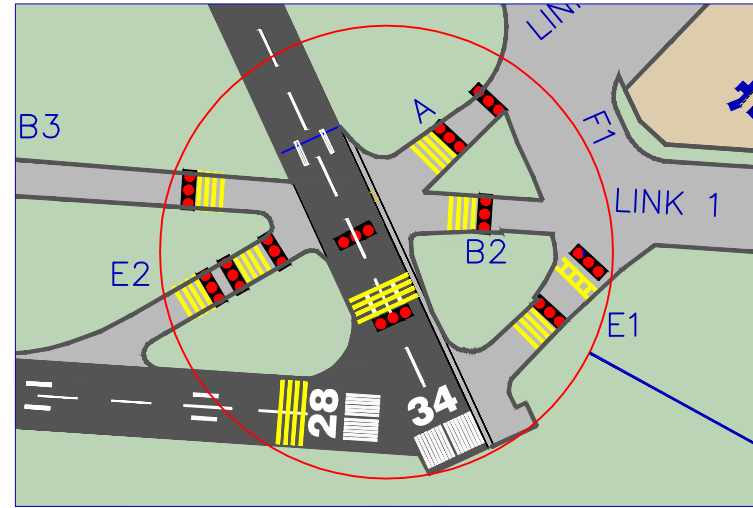

NOTE 1: RWY 10/28 IS PROVIDED WITH 7.5M WIDE ASPHALT SHOULDERS.
 NOTE 2: ALL TAXIWAYS 23M WIDE EXCEPT TWY R: 15M, LINK 1: 33M, LINK 2: 65M, LINK 3: 42M, LINK 4: 73M, B1 AND B2: 24M, E6: 30M, F1: 25M

HOTSPOT HS1
 Dual RWY Threshold. Ensure Correct line up. Multiple runway entry points and converging taxiways. Potential for TWY confusion, disorientation, wingtip collision and RWY incursion. Pay attention to signage and ATC instruction. Pilots must ensure wingtip clearance.

ANNUAL RATE OF CHANGE - 11' W



PRECISION APPROACH CAT I LIGHTING SYSTEM

RADAR MSSR 2
272 (30)

RADAR MSSR 1
281 (39)

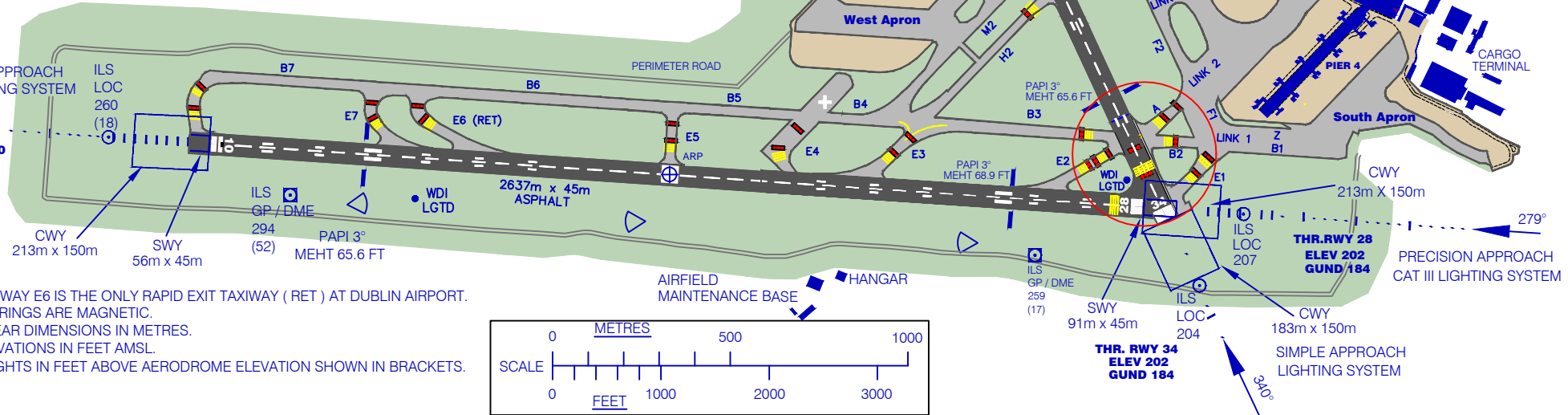

NOTE 3: TAXIWAY E6 IS THE ONLY RAPID EXIT TAXIWAY (RET) AT DUBLIN AIRPORT.
 NOTE 4: BEARINGS ARE MAGNETIC.
 NOTE 5: LINEAR DIMENSIONS IN METRES.
 NOTE 6: ELEVATIONS IN FEET AMSL.
 NOTE 7: HEIGHTS IN FEET ABOVE AERODROME ELEVATION SHOWN IN BRACKETS.

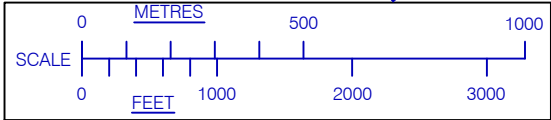

CHANGES: SOUTH APRON EXTENDED